



---

**IT-G600**  
**IT-G650**

Data capture  
at its best

---

**CASIO**

Mobile Industrial Solutions

# Two models, one leader board

Touchscreen or keys? With different models for different user needs, you have the choice! The new flagship among CASIO mobile computers is available as the IT-G600 with an ergonomic, 10-digit keypad and as the IT-G650 with a 5.5" full screen. The two models have a lot in common, though: both handheld terminals are perfectly designed for a wide range of application areas, such as retail, transport or logistics. Both feature the innovative, ergonomic CasioScan25° function (learn more about this on the inside).

Both models have network access no matter where they are, at home or in the field, thanks to full connectivity via Wi-Fi, LTE and Bluetooth®. Both models are IP67 compliant, giving them optimal protection against drops, dust, heat and cold. And finally, Android Enterprise Recommended allows for a number of apps to be installed and makes updates a breeze.



## Can handle any use

It can easily take drops onto concrete from up to 1.8 m – and even 2.5 m with the protective bumper. And thanks to the IP67 compliant, dust and water have no chance of getting through.

## CASIO IT-G600

The classic 10-digit keyboard with ergonomic optimisation makes it easier to use while wearing gloves and to type without looking.

## Adaptable

Android™ 9 makes using in-house apps a breeze. The interface on the back connects extension modules to the device.

ANDROID™

9



ANDROID  
ENTERPRISE  
RECOMMENDED

PROTECTION RATING

IP67

APPROX. WEIGHT

300 g\*

\*RESP. 310 g

LARGE DISPLAY

4.7"

DROP RESISTANCE

1.8 m\*

\*2.5m WITH BUMPER

# Two models, one leader board

Touchscreen or keys? With different models for different user needs, you have the choice! The new flagship among CASIO mobile computers is available as the IT-G600 with an ergonomic, 10-digit keypad and as the IT-G650 with a 5.5" full screen. The two models have a lot in common, though: both handheld terminals are perfectly designed for a wide range of application areas, such as retail, transport or logistics. Both feature the innovative, ergonomic CasioScan25° function (learn more about this on the inside).

Both models have network access no matter where they are, at home or in the field, thanks to full connectivity via Wi-Fi, LTE and Bluetooth®. Both models are IP67 compliant, giving them optimal protection against drops, dust, heat and cold. And finally, Android Enterprise Recommended allows for a number of apps to be installed and makes updates a breeze.

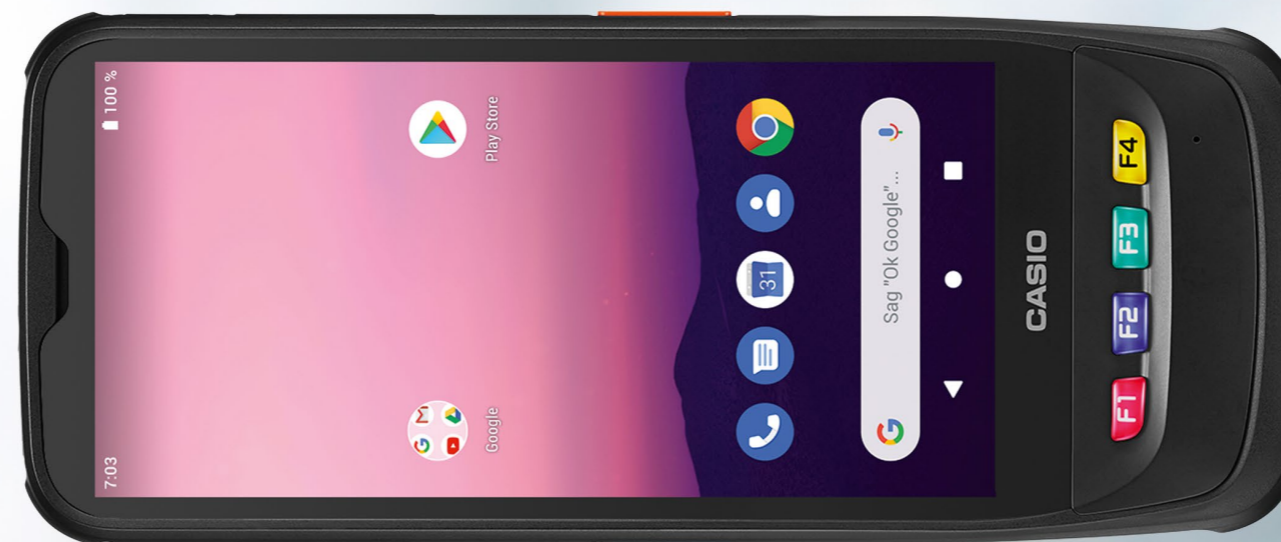

## Fits well in your palm

The narrow, round grip area, the trigger keys on the side and a light weight of just 310 g make pleasant work of the job.

## CASIO IT-G650

All information can be seen at a glance on the generous 5.5-inch full screen.

## Fully equipped

The 2D imager, NFC, Wi-Fi, LTE, Bluetooth® and 13 megapixel camera cover every situation.

ANDROID™

9



ANDROID  
ENTERPRISE  
RECOMMENDED

PROTECTION RATING

IP67

APPROX. WEIGHT

300 g\*

\*RESP. 310 g

LARGE DISPLAY

5.5"

DROP RESISTANCE

1.5 m\*

\*2,1m WITH BUMPER

# Barcode scanning without limits – thanks to **CasioScan25°**

---

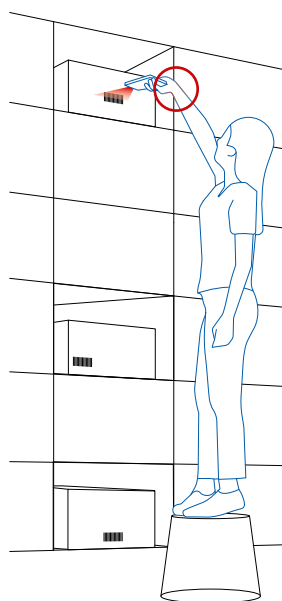

Conventional barcode scanner

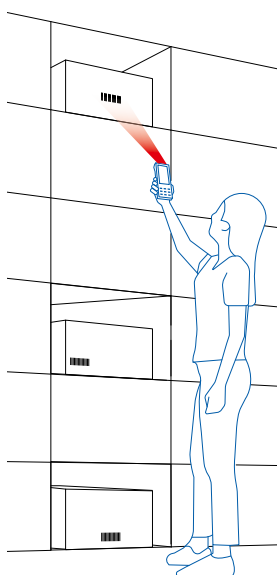

CasioScan25°

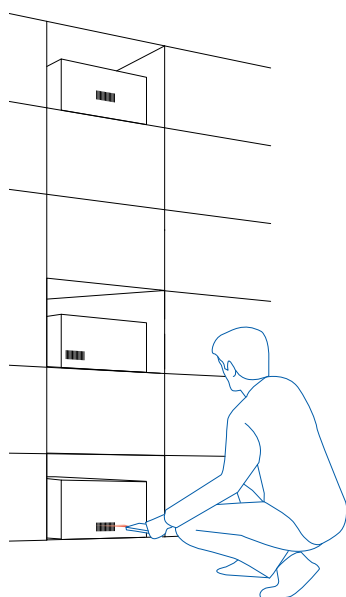

Conventional barcode scanner

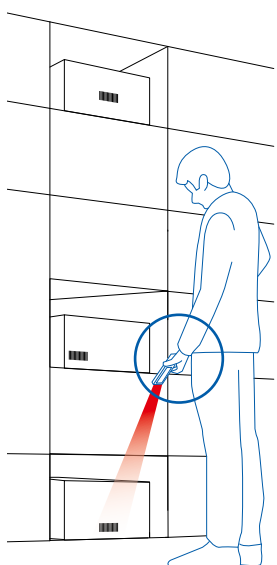

CasioScan25°

Reading barcodes is one of the most important tasks a professional mobile computer undertakes, especially in retail. The scanner hardware is normally positioned on the front of the device – meaning that barcodes can only be scanned at one specific angle.

Thanks to our especially ergonomic design we have redefined barcode scanner hardware: the 25° tilt of the scanner unit means that barcodes at foot and waist level and even overhead can be read, all while holding the device in a natural way.

This design allows for fatigue-free work – and helps to minimise health-related downtime in the long term.

Model	IT-G600 (10-digit keyboard)		IT-G650 (Full Screen)	
Type of model	IT-G600-C21	IT-G600-WC21	IT-G650-C21	IT-G650-WC21
WWAN	–	Yes	–	Yes
CPU	Qualcomm SD660 (Octa Core 2,2 GHz)			
OS	Android™ 9 (Android Enterprise Recommended)			
Memory	RAM	4 GB		
	FROM	64 GB		
Display	Screen Size	4.7 inch (119 mm)	5.5 inch (140 mm)	
	Number of dots	HD (1280 x 720)	HD+ (1440 x 720)	
Indicators	LED	for charging / for status		
	Speaker	over 75 db (30 cm distance)		
Input	Touch Panel	Capacitive Multi-Touch (Dragontrail Pro®)		
	2D Imager	Scanner unit angle by 25° with Laser Aimer		
	Camera	13 megapixel, Auto focus, LED Flash		
	LED Flash	Enough brightness with 30 cm distance		
	Keys with white backlite	Power, Volume up / down		Function (F1 to F4), Trigger (R/L)
	Reset Switch	10 keys (alpha numeric), Function (F1 to F4), Trigger (Center/R/L)		
Sensors	Hardware Reset			
	Acceleration, Light Ambient, Proximity, Gyroscope, Geomagnetic (compass) sensor			
Wireless Communication	Bluetooth®	Ver. 5.0 EDR/LE		
	WLAN (WIFI)	IEEE802.11a/b/g/n/ac, 11mc		
	WWAN (model dependent)	LTE, WCDMA Band 1/6/8 (3G Voice communication complied), GSM 900 / GSM 1800		
	GPS	GPS, GLONASS, Michibiki (QZSS/L1)		
RFID/NFC Functionality	NFC Standards	ISO14443Type A/B/FeliCa (R), ISO15693, Output Power over 3.5 A/m		
USB	USB 2.0 (Host/Client), USB Type-C (Power supply over 2,000 mA)			
Charging station port	USB 2.0			
SD Card	microSD (SDXC)			
SIM	nano SIM			
Extention port (for Local Development)	(RFID/NFC, Legic Reader solutions)			
Battery	Main Power	Lithium-ion battery, Approx. 20 hours (JEITA G-mode)	Lithium-ion battery, Approx. 18 hours (JEITA G-mode)	
	Capacity	Integrated Lithium-ion battery with 3,000 mAh		
	Backup Time	RAM Backup: over 4 minutes		
RTC Backup: over 72 hours				
External Dimensions (W x D x H)	approx. 75 x 180 x 18 mm		approx. 78 x 180 x 18 mm	
Weight	approx. 300 g (including battery)		approx. 310 g (including battery)	
Durability	Dust / Water proof	IP67		
	Drop Durability	1.8 m and with Bumper 2.5 m onto concrete	1.5 m and with Bumper 2.1 m onto concrete	
	Temparature	Operation -20 to 50 °C / Non-operation -20 to 60 °C		
	Humidity	Operation 30 to 80 % RH / Non-operation 5 to 90 % RH		

Android, Google Maps, Google Mail, Google Play, Google Drive, Hangout and Chrome are registered trademarks of Google, Inc., USA. MIFARE is a registered trademark of the NXP B.V. FeliCa is a registered trademark of the Sony Corporation. The BLUETOOTH® trademark is owned by Bluetooth SIG, Inc., USA, and licensed to CASIO Computer Co., Ltd. Other product- and company names are either trademarks or registered trademarks of the respective owners. The design and specifications may vary without notice. The color display of pictures may vary from the actual colours. Screen images are simulated representations. The specifications in the table above were provided in February 2020.

CASIO grants a warranty period of 12 months on all CASIO System products (cash registers and handy terminals).

#### Casio Europe GmbH

Casio-Platz 1  
22848 Norderstedt, Germany  
solutions@casio.de  
+49 (0)40 528 65-407  
www.casio-solutions.com